



SPZ FRONTAL
SWEEPER BUCKET



HB400



SKID LOADER



SKID LOADER



WHEEL LOADER



BACKHOE LOADER









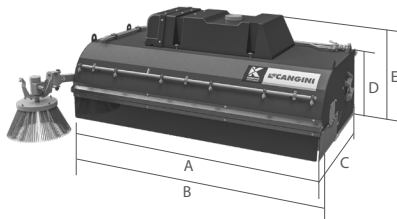

TELEHANDLER



NB: AT THE TIME OF ORDER, PLEASE NOTIFY THE VOLTAGE OF THE ELECTRICAL SYSTEM (12-24 V)

THE SPZ SWEEPER IS EVEN MORE COMPACT THANKS TO THE SHAFT WITH INTEGRATED ENGINE, WHICH REDUCES ITS SIZE AND INCREASES ITS ERGONOMICS AND VISIBILITY FROM THE CAB. THE IDEAL EQUIPMENT FOR DEEP CLEANING OF ANY SURFACE. IT IS EQUIPPED WITH A COLLECTION TANK WITH BOLT-ON REVERSIBLE HB400 CUTTING EDGE, WHICH MAKES THE SWEEPER EVEN MORE RESISTANT.



	W/O COUPLER	KG (LB)	190 (418)	314 (692)	342 (753)	370 (815)	420 (925)	450 (992)
	FULL-LOAD	L (GAL)	80 (21)	185 (49)	210 (55)	240 (63)	280 (74)	305 (81)
 		MM (IN)	450 (18)	600 (24)	600 (24)	600 (24)	600 (24)	600 (24)
		N.	24 + 2	28 + 2	32 + 2	37 + 2	43 + 2	48 + 2
		L/MIN (GAL/MIN)	50 (13)	70 (19)	70 (19)	70 (19)	70 (19)	70 (19)
	MAX	BAR (PSI)	180 (2610)	250 (3626)	250 (3626)	250 (3626)	250 (3626)	250 (3626)

* THE CONNECTOR TYPE YOU REQUIRE MUST BE INDICATED AT THE TIME OF ORDERING, OTHERWISE THE 14-PIN CONNECTOR WILL BE SUPPLIED AS STANDARD.

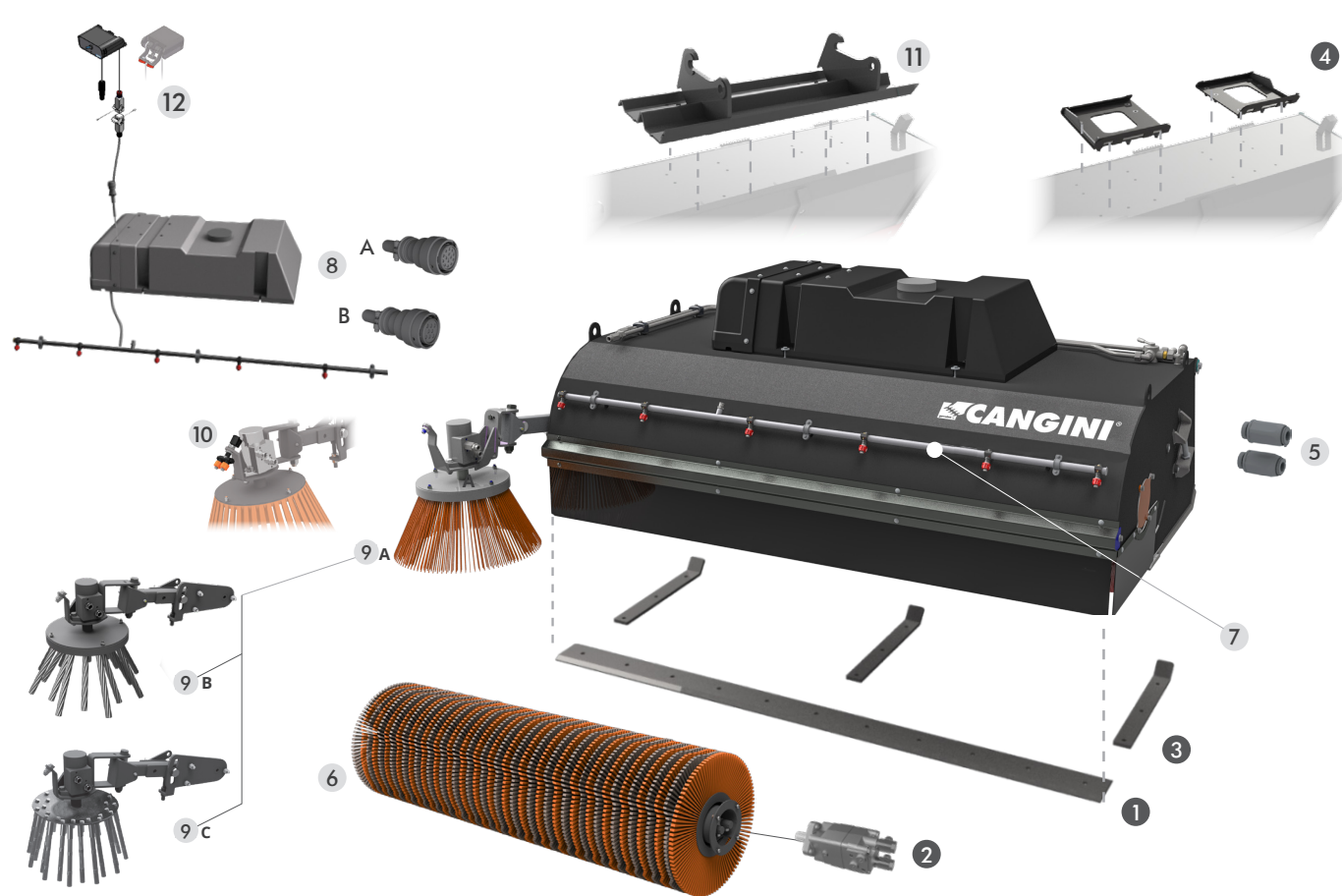

STANDARD TECHNICAL FEATURES

- BOLT-ON REVERSIBLE HB400 CUTTING EDGE (SPZ120 EXCLUDED)**
- ENGINE WITH SQUARE FLANGES AND DISK GEARBOX**
SHAFT WITH INTEGRAL MOTOR, NOT SUITABLE FOR HIGH FLOW SYSTEM
- INTERCHANGEABLE SKIDS**
THEY ENSURE AN OPTIMAL WORKING POSITION. ONCE WORN OUT, THEY CAN BE REPLACED TO RESTORE THEIR ORIGINAL EFFICIENCY.
- SKID-STEER LOADER HITCH**

NB : THE EQUIPMENT IS SUPPLIED COMPLETE WITH PIPES AND CONNECTIONS

OPTIONAL

- FLOWRATE REDUCERS**
MANDATORY ON HIGHFLOW MACHINES OR WITH OILRATE HIGHER THAN 70 L/MIN.
- PPL + STEEL BRUSH**
FOR PARTICULARLY ABRASIVE SURFACES. (SPZ120 EXCLUDED).
- INSIDE SPRINKLERS**
THE KIT DOES NOT INCLUDE THE WATER TANK AND THE PRESSURE WATER PUMP. IT CAN BE EMPLOYED ONLY WHEN THE MACHINE ITSELF IS EQUIPPED WITH A WATER TANK. (ONLY EXTERNAL ON SPZ120)
- DUST-CONTROL SYSTEM WITH TANK AND PUMP**
PRESSURIZED WATER SYSTEM WITH TANK FOR THE CONTROL OF DUSTS PRODUCED DURING THE WORKING CYCLE. SPRINKLERS ARE POSITIONED OUTSIDE THE SWEEPER. THE STANDARD 14-PIN PLUG IS SUPPLIED WITH DUST-CONTROL SYSTEM*
- PPL BRUSH (A) STEEL BRUSH + RUBBER PLATE (B) STEEL BRUSH + STEEL PLATE (C) (SPZ120 EXCLUDED)**
INDICATED FOR CURBS, WALLS AND SIDEWALKS CLEANING.
- SPRINKLERS FOR SIDE BRUSH (SPZ120 EXCLUDED)**
- HITCH FOR ARTICULATED LOADERS, BACKHOE LOADERS AND TELEHANDLER HANDLERS.**
- 7 PIN CONNECT / ELECTRIC KIT**
THE CONNECTOR TYPE YOU REQUIRE MUST BE INDICATED AT THE TIME OF ORDERING.

*THE PLUG IS SUPPLIED DISASSEMBLED, IF NO INFORMATION ON THE PLUG WIRING IS PROVIDED, PLEASE CHECK THAT THE MAIN MACHINE IS EQUIPPED WITH A 14/8-PIN MULTIPOLE SOCKET. ON THE CONTRARY, TH ELECTRICAL KIT IS REQUIRED.

