

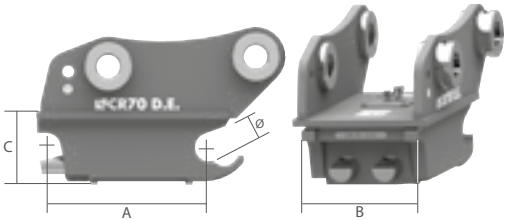

NB: AT THE TIME OF ORDER, PLEASE NOTIFY THE VOLTAGE OF THE ELECTRICAL SYSTEM (12-24 V)

THE CR TWIN LOCK D.E. QUICK COUPLER, WITH ITS **DOUBLE ACTION** SYSTEM, MANAGES THE LOCKING AND UNLOCKING OPERATIONS DIRECTLY FROM THE CAB IN A FEW SECONDS. IT MEETS THE HIGHEST RELIABILITY STANDARDS THANKS TO ITS SAFETY SYSTEMS, **SUCH AS THE VISUAL INDICATOR FOR THE LOCKING STATUS CONTROL, THE STANDARD BLOCK VALVE, THE DOUBLE-NOTCH PROFILE OF THE FORK**. THE SIDES ARE REALIZED ENTIRELY WITH THE HB400 STEEL, GRANTING GREAT RESISTANCE.

HYDRAULIC DOUBLE ACTION



	TONS (LB)	0,6 - 1,8 (1323 - 3968)	1,8 - 2,5 (3968 - 5512)	2,5 - 4,0 (5512 - 8819)	4,0 - 6,0 (8819 - 13228)	6,0 - 12,0 (13228 - 26455)
MOD.		CR15 D.E.	CR30 D.E.	CR40 D.E.	CR50 D.E.	CR70 D.E.
A	MM (IN)	247 (9,7)	252 (9,9)	260 (10,2)	290 (11,4)	345 (13,5)
B	MM (IN)	156 (6,1)	180 (7,1)	196 (7,7)	218 (8,6)	257 (10,1)
C	MM (IN)	101 (4,0)	107 (4,2)	109 (4,3)	133 (5,2)	148 (5,8)
Ø	MM (IN)	40 (1,6)	45 (1,8)	45 (1,8)	50 (2,0)	60 (2,4)
	KG (LB)	17,5 (40)	23 (49)	27 (60)	42 (84)	68 (135)
	BAR (PSI)	200 (2901)	200 (2901)	200 (2901)	200 (2901)	200 (2901)



STANDARD TECHNICAL FEATURES

- FORK'S DOUBLE PROFILE**
NEW DOUBLE CRADLE PROFILE CREATE A GREATER OBSTACLE TO THE ACCIDENTAL FALL OF THE TOOL.
- FRONT SAFETY SYSTEM**
THROUGH TO THE VISUAL INDICATOR PLACED IN THE COUPLER, THE VISUALISATION OF THE LOCKING CONDITION IS SIMPLE AND IMMEDIATE.
A LOCKING PINS **B** UNLOCKIN PINS
- SAFETY BLOCK VALVE**
IT ALLOWS THE QUICK COUPLER TO HOLD ITS POSITION EVEN IN THE CASE OF A PRESSURE LOSS ON THE HYDRAULIC LINE.
- "SAFE CHECK" SIDE COUPLING INDICATOR**
THE 'SAFE CHECK' SIDE INDICATOR ALLOWS FULL CONTROL OF THE COUPLING STAGE. IT ALLOWS YOU TO CHECK THAT THE QUICK COUPLING IS SAFELY ENGAGED.

OPTIONAL

- HYDRAULIC INSTALLATION KIT**
THIS KIT CAN BE SUPPLIED WITH THE QUICK COUPLER HYDRAULIC VERSION. SUPPLIED WITH WIRED SOLENOID VALVE AND CONTROL SWITCH.
- LIFTING HOOK**
A HOOK APPROVED FOR LIFTING OPERATIONS CAN BE WELDED DIRECTLY ON THE QUICK COUPLER.
- CR ADAPTE**
THE CR ADAPTER MAKES THE TOOL REVERSIBLE.