



HB400 REINFORCEMENTS ON THE AREAS OF MAJOR WEAR, CAST SIDE CUTTERS AND A BOLTED-IN REVERSIBLE UNDERBLADE MAKE THIS BUCKET SUITABLE FOR WORKS ON ABRASIVE SOILS. IT'S THE IDEAL TOOL FOR FINISHING AND LEVELLING WORKS. ITS TILTING MECHANISM ENABLES TO TILT THE BUCKET BY 45° ON BOTH SIDES. THE STANDARD BLOCK VALVE ENABLES TO KEEP THE ANGLE.

**THE INSTALLATION OF BEZELS IS HIGHLY RECOMMENDED FOR BUCKETS WIDER THAN 1400 MM, IN ORDER TO AVOID DAMAGES TO THE BUCKET IN CASE OF HEAVY DUTY JOBS OR WITH PARTICULARLY HARD TERRAINS:**

- WIDTH FROM 1400 TO 1500 MM: NR. 1 BEZEL
- WIDTH FROM 1600 TO 1600 MM: NR. 2 BEZELS
- WIDTH FROM 1800 TO 2200 MM: NR. 3 BEZELS

MOD.	MIDI					EXCAVATOR		
	SQR35	SQR40	SQR45	SQR50	SQR55	SQR60	SQR65 HD	SQR70 HD
TONS (LB)	1,8 - 2,5 (3968 - 5512)	2,5 - 4,0 (5512 - 8818)	4,0 - 5,0 (8818 - 11023)	5,0 - 7,5 (11023 - 16535)	7,5 - 10,0 (16535 - 22046)	10,0 - 12,0 (22046 - 26455)	12,0 - 18,0 (26455 - 39683)	18,0 - 22,0 (39683 - 48502)

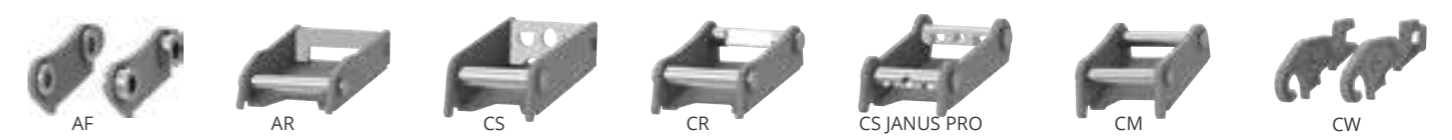

ADAPTERS

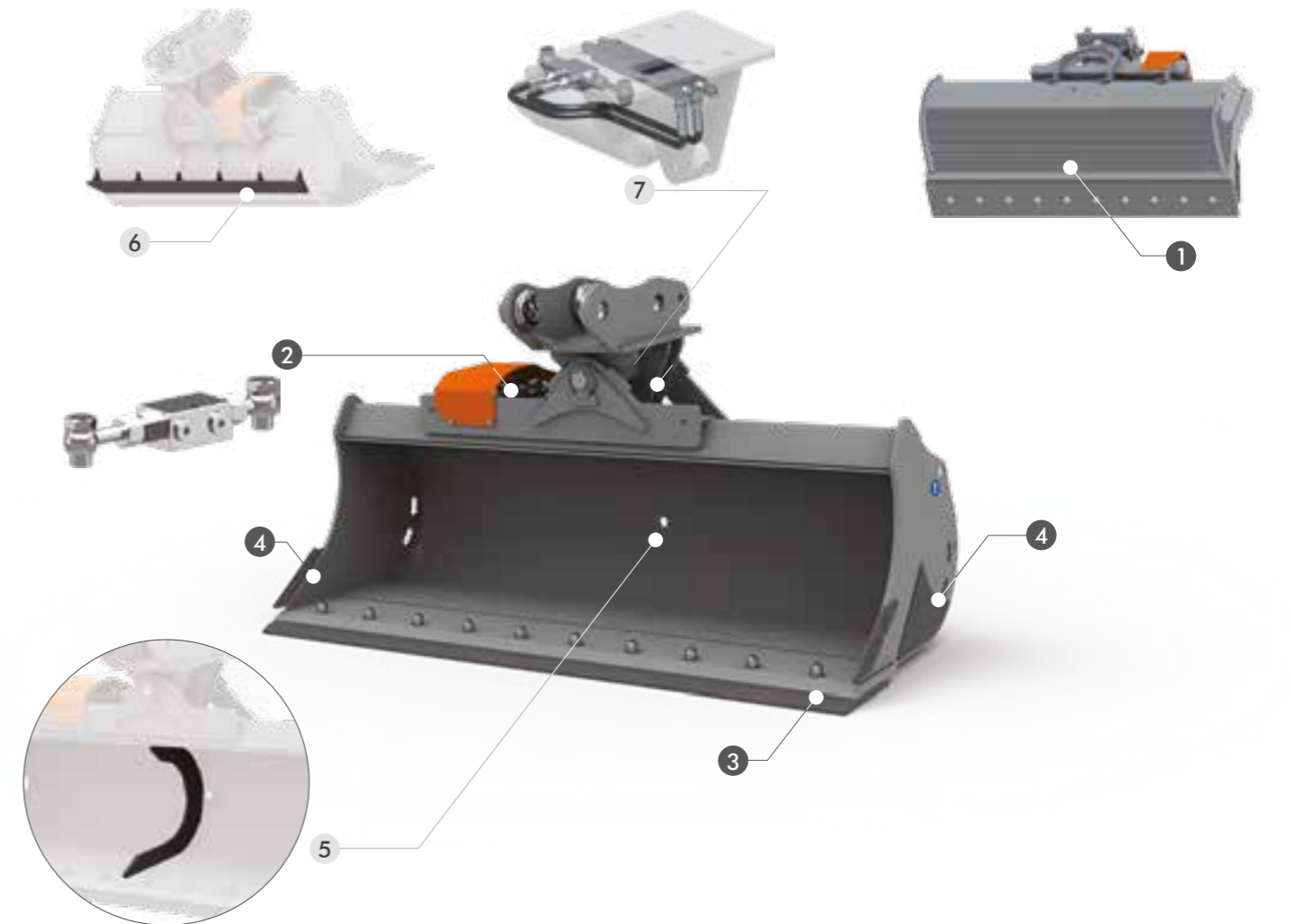

## STANDARD TECHNICAL FEATURES

- 1 REINFORCING STRIPS 400HB**  
THE HORIZONTAL REINFORCING STRIPS ON THE BUCKET'S REAR AND BOTTOM PROTECT THE BUCKET FROM WEAR AND INCREASE ITS RESISTANCE.
- 2 BLOCK VALVE**  
IT ALLOWS TO KEEP THE BUCKET POSITIONING DURING THE WORKING PHASE.
- 3 HB400 ADDITIONAL BOLT-ON REVERSIBLE CUTTING EDGE**  
BOLTED-IN HB400 REVERSIBLE UNDERBLADE. RECOMMENDED TO WORK ON PARTICULARLY ABRASIVE SOILS.
- 4 HB400 SIDE CAST CUTTERS AND REINFORCEMENTS**  
THESE HB400 CAST CUTTERS ARE POSITIONED ON THE SURFACES MOSTLY SUBJECT TO WEAR GRANTING A HIGHER RESISTANCE.

## OPTIONAL

- 5 BEZEL**  
IT ENSURES A HIGHER STRUCTURAL RESISTANC. **HIGHLY RECOMMENDED WITH BUCKETS 1400MM WIDE OR MORE.**
- 6 REAR RAZOR**  
WHEN THE MACHINE'S ARM IS KEPT CLOSED, IT ALLOWS TO FINISH SURFACES EVENLY.
- 7 PIPE KIT**  
OPTIONAL KIT INSTALLED ON THE BUCKET FOR THE FEEDING OF THE HYDRAULIC CYLINDER. IT ALLOWS THE USE OF TWO OUTLETS ON THE RIGHT AND TWO OUTLETS ON THE LEFT FOR THE HYDRAULIC CONNECTION TO THE MACHINE REDUCING THE INSTALLATION TIMES. THE CONNECTING PIPES ARE NOT SUPPLIED.

## SQR35 MACHINE WEIGHT - 1,8 - 2,5 t (3968 - 5512 lb)

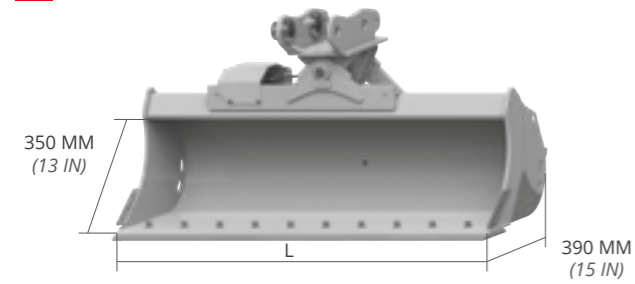

L MM (IN)	WEIGHT KG* (LB*)	CAP. SAE L (GAL)	ADAPTERS
800 (31)	95 (210)	75 (19,8)	AF - AR - CS CR - CM CW - CS JANUS PRO
1000 (39)	109 (239)	96 (25,4)	AF - AR - CS CR - CM CW - CS JANUS PRO
1200 (47)	122 (269)	117 (30,9)	AF - AR - CS CR - CM CW - CS JANUS PRO

### OPTIONAL

- 7 REAR RAZOR
- 8 PIPE KIT

## SQR40 MACHINE WEIGHT 2,5 - 4,0 t (5512 - 8818 lb)

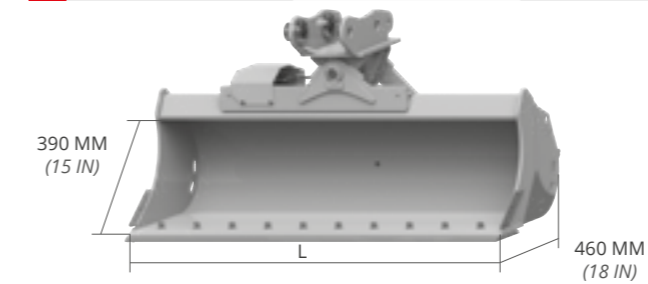
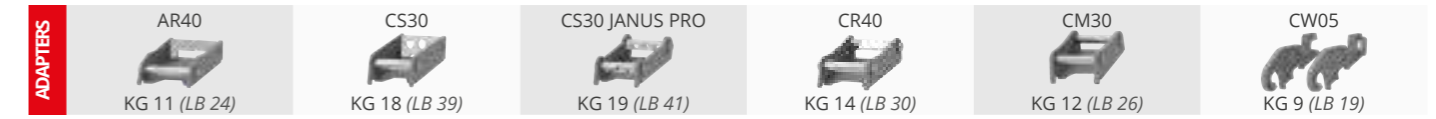

L MM (IN)	WEIGHT KG* (LB*)	CAP. SAE L (GAL)	ADAPTERS
1000 (39)	166 (365)	125 (33,0)	AF - AR - CS CR - CM CW - CS JANUS PRO
1200 (47)	186 (410)	154 (40,7)	AF - AR - CS CR - CM CW - CS JANUS PRO
1400 (55)	206 (454)	182 (48,1)	AF - AR - CS CR - CM CW - CS JANUS PRO

### OPTIONAL

- 6 BEZEL
- 7 REAR RAZOR
- 8 PIPE KIT

## SQR45 MACHINE WEIGHT 4,0 - 5,0 t (8818 - 11023 lb)

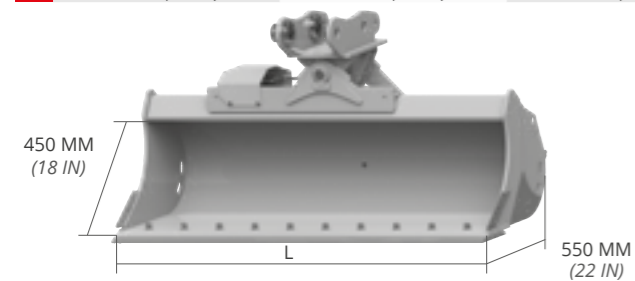
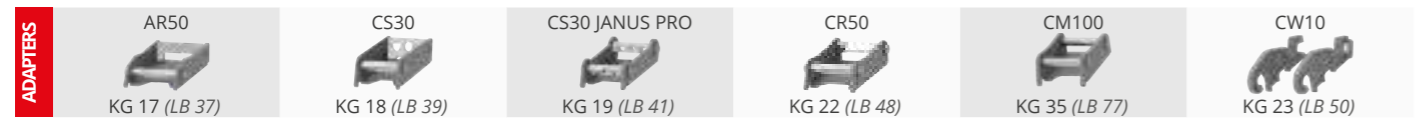

L MM (IN)	WEIGHT KG* (LB*)	CAP. SAE L (GAL)	ADAPTERS
1200 (47)	243 (537)	213 (56,3)	AF - AR - CS CR - CM CW - CS JANUS PRO
1400 (55)	268 (591)	254 (67,1)	AF - AR - CS CR - CM CW - CS JANUS PRO
1500 (59)	280 (617)	274 (72,4)	AF - AR - CS CR - CM CW - CS JANUS PRO

### OPTIONAL

- 6 BEZEL
- 7 REAR RAZOR
- 8 PIPE KIT

## SQR50 MACHINE WEIGHT 5,0 - 7,5 t (11012 - 16535 lb)

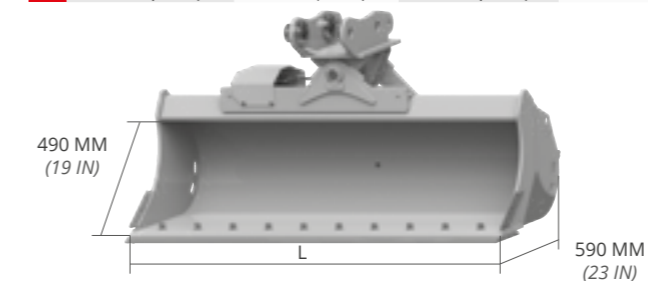
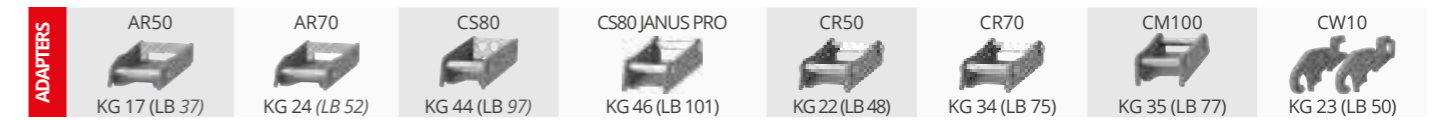

L MM (IN)	WEIGHT KG* (LB*)	CAP. SAE L (GAL)	ADAPTERS
1200 (47)	267 (588)	250 (66,0)	AF - AR - CS CR - CM CW - CS JANUS PRO
1400 (55)	294 (648)	298 (78,8)	AF - AR - CS CR - CM CW - CS JANUS PRO
1600 (63)	322 (710)	345 (91,1)	AF - AR - CS CR - CM CW - CS JANUS PRO
1800 (71)	349 (770)	392 (103,6)	AF - AR - CS CR - CM CW - CS JANUS PRO

### OPTIONAL

- 6 BEZEL
- 7 REAR RAZOR
- 8 PIPE KIT

\* weight of the tank excluding attachment

\* weight of the tank excluding attachment



## SQR55 MACHINE WEIGHT 7,5 - 10,0 t (16535 - 22046 lb)

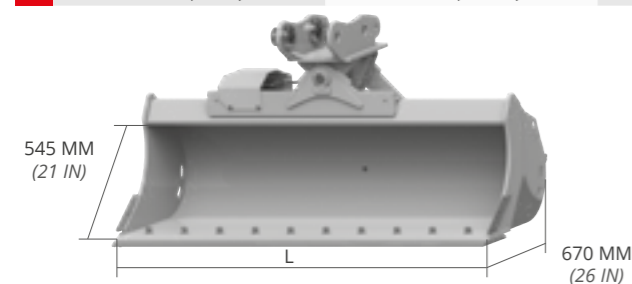

L MM (IN)	WEIGHT KG* (LB*)	CAP. SAE L (GAL)	ADAPTERS
1200 (47)	347 (764)	326 (86,1)	AF - CS
			CR - CM
			CW - CS JANUS PRO
1400 (55)	380 (838)	387 (102,2)	AF - CS
			CR - CM
			CW - CS JANUS PRO
1600 (63)	415 (915)	447 (118,1)	AF - CS
			CR - CM
			CW - CS JANUS PRO
1800 (71)	449 (991)	507 (133,9)	AF - CS
			CR - CM
			CW - CS JANUS PRO

### OPTIONAL

6	7	8
BEZEL	REAR RAZOR	PIPE KIT

## SQR60 MIDI MACHINE WEIGHT 10,0 - 12,0 t (22046 - 26455 lb)

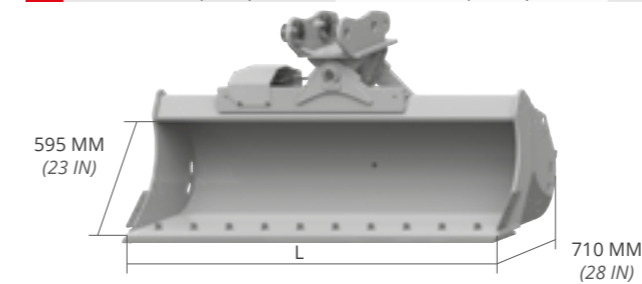

L MM (IN)	WEIGHT KG* (LB*)	CAP. SAE L (GAL)	ADAPTERS
1200 (47)	386 (851)	367 (97,0)	AF - CS
			CR - CM - CS JANUS PRO
			CW
1400 (55)	424 (935)	436 (115,2)	AF - CS
			CR - CM - CS JANUS PRO
			CW
1600 (63)	464 (1024)	504 (133,1)	AF - CS
			CR - CM - CS JANUS PRO
			CW
1800 (71)	502 (1108)	573 (151,4)	AF - CS
			CR - CM - CS JANUS PRO
			CW
2000 (79)	540 (1191)	641 (169,3)	AF - CS
			CR - CM - CS JANUS PRO
			CW

### OPTIONAL

6	7	8
BEZEL	REAR RAZOR	PIPE KIT

## SQR65 HD EXCAVATOR MACHINE WEIGHT 12,0 - 18,0 t (26455 - 39683 lb)

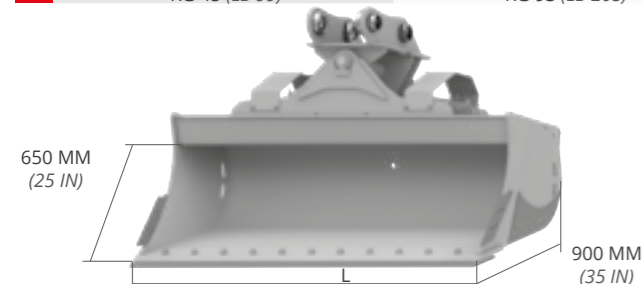
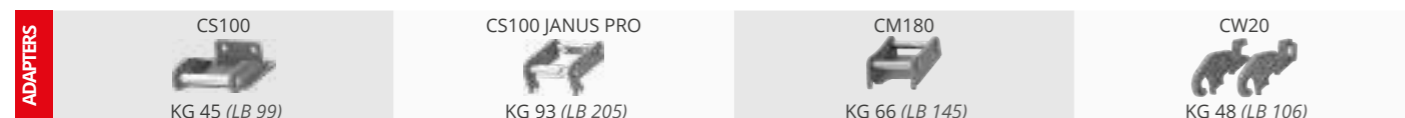

L MM (IN)	WEIGHT KG* (LB*)	CAP. SAE L (GAL)	ADAPTERS
1400 (55)	532 (1173)	631 (166,7)	AF - CM
			CS - CW
			CS JANUS PRO
1500 (59)	558 (1230)	665 (175,7)	AF - CM
			CS - CW
			CS JANUS PRO
1600 (63)	583 (1285)	699 (184,7)	AF - CM
			CS - CW
			CS JANUS PRO
1800 (71)	634 (1398)	767 (202,6)	AF - CM
			CS - CW
			CS JANUS PRO
2000 (79)	684 (1508)	835 (220,6)	AF - CM
			CS - CW
			CS JANUS PRO

### OPTIONAL

6	7	8
BEZEL	REAR RAZOR	PIPE KIT

## SQR70 HD MACHINE WEIGHT 18,0 - 22,0 t (39683 - 48502 lb)

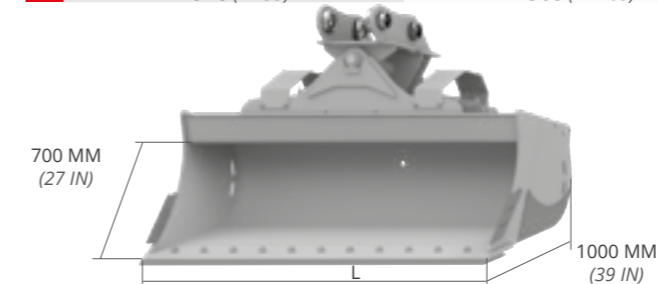
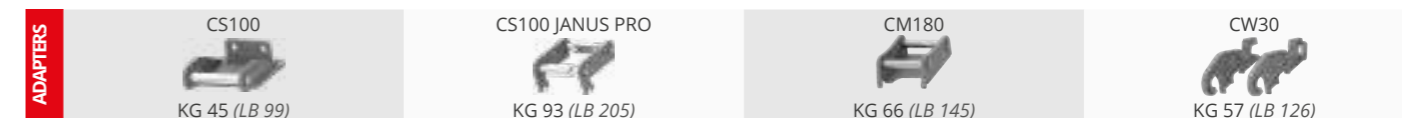

L MM (IN)	WEIGHT KG* (LB*)	CAP. SAE L (GAL)	ADAPTERS
1500 (59)	650 (1434)	780 (206,1)	AF - CM
			CS - CW
			CS JANUS PRO
1600 (63)	681 (1501)	820 (216,6)	AF - CM
			CS - CW
			CS JANUS PRO
1800 (71)	742 (1635)	900 (237,8)	AF - CM
			CS - CW
			CS JANUS PRO
2000 (79)	800 (1765)	980 (258,9)	AF - CM
			CS - CW
			CS JANUS PRO
2200 (87)	857 (1890)	1060 (280,0)	AF - CM
			CS - CW
			CS JANUS PRO

### OPTIONAL

6	7	8
BEZEL	REAR RAZOR	PIPE KIT

\* weight of the tank excluding attachment

\* weight of the tank excluding attachment