

INDEX

STANDARD DIGGING BUCKET _____	SC85 _____	PAG. 380
STANDARD DITCH CLEANING BUCKET _____	SP60 _____	PAG. 382
STANDARD PIVOTING DITCH CLEANING BUCKET _____	SQ60 _____	PAG. 384
REINFORCED DIGGING BUCKET _____	SCR85 _____	PAG. 386
REINFORCED STONE BUCKET _____	SB85 _____	PAG. 388
REINFORCED DITCH CLEANING BUCKET _____	SPR60 _____	PAG. 390
REINFORCED PIVOTING DITCH CLEANING BUCKET _____	SQR60 _____	PAG. 392

STANDARD DIGGING BUCKET

Standard digging bucket suitable for medium hard soils. Available in different sizes depending on the employment. All buckets can be equipped with welded capsule teeth.

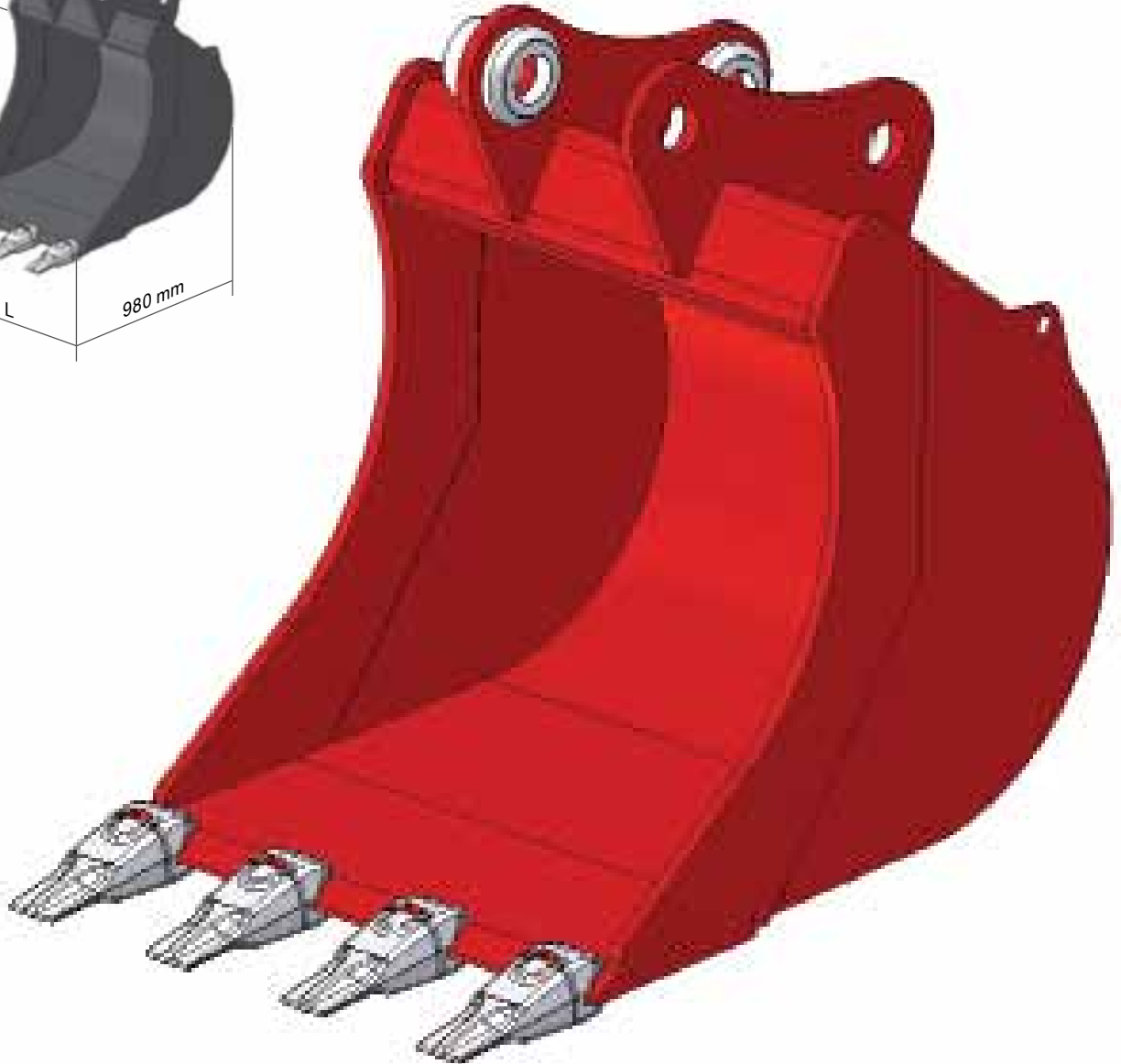
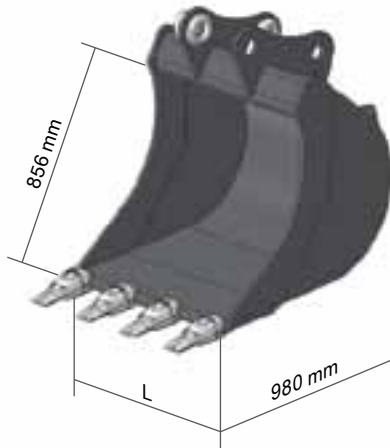

ADAPTERS



CR70

pag.86



CS80

pag.88



CS80 JANUS

pag.88



CW AUTOLOCK 10

pag.90

TECHNICAL SPECIFICATION

L/mm	*	CAP. SAE	N° TEETH	ATTACHMENT
400	170	171	3	AF
400	170	171	3	CR
400	170	171	3	CS
400	170	171	3	CS Janus
400	170	171	3	CW
500	190	235	3	AF
500	190	235	3	CR
500	190	235	3	CS
500	190	235	3	CS Janus
500	190	235	3	CW
600	210	300	4	AF
600	210	300	4	CR
600	210	300	4	CS
600	210	300	4	CS Janus
600	210	300	4	CW
700	230	368	4	AF
700	230	368	4	CR
700	230	368	4	CS
700	230	368	4	CS Janus
700	230	368	4	CW
800	250	438	5	AF
800	250	438	5	CR
800	250	438	5	CS
800	250	438	5	CS Janus
800	250	438	5	CW
900	270	510	5	AF
900	270	510	5	CR
900	270	510	5	CS
900	270	510	5	CS Janus
900	270	510	5	CW
1000	295	584	5	AF
1000	295	584	5	CR
1000	295	584	5	CS
1000	295	584	5	CS Janus
1000	295	584	5	CW
1100	315	657	5	AF
1100	315	657	5	CR
1100	315	657	5	CS
1100	315	657	5	CS Janus
1100	315	657	5	CW
1200	335	730	6	AF
1200	335	730	6	CR
1200	335	730	6	CS
1200	335	730	6	CS Janus
1200	335	730	6	CW
1300	355	810	6	AF
1300	355	810	6	CR
1300	355	810	6	CS
1300	355	810	6	CS Janus
1300	355	810	6	CW

* the weight of the bucket is calculated without attachment and teeth

OPTIONAL



SAVE BLADE WELDED KIT + SIDE CUTTER KIT

L/mm			L/mm		
400			900		
500			1000		
600			1100		
700			1200		
800			1300		

OPTIONAL

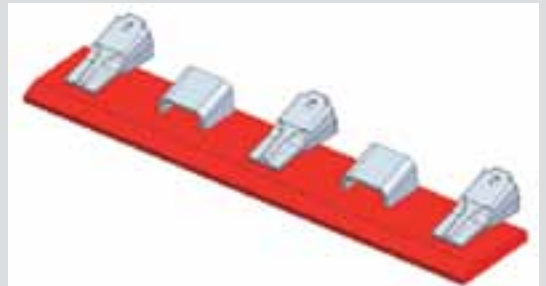

ADDITIONAL CUTTING EDGES

L/mm		L/mm	
400		900	
500		1000	
600		1100	
700		1200	
800		1300	

OPTIONAL



TWIST 225

pag.94

OPTIONAL

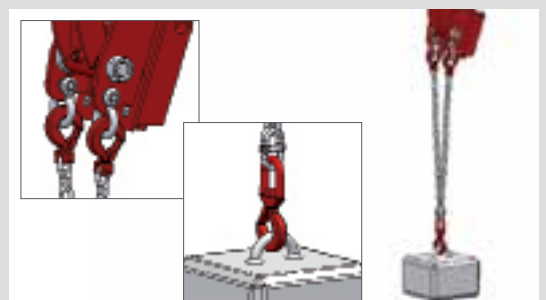

MOVEMENT HOOK

REINFORCED DITCH CLEANING BUCKET

Evolution of the standard ditch cleaning bucket. The application of HB400 reinforcements at points of increased wear (bottom and sides), the application of side welded cutters and the additional bolted blade make this bucket suitable for hard surfaces.

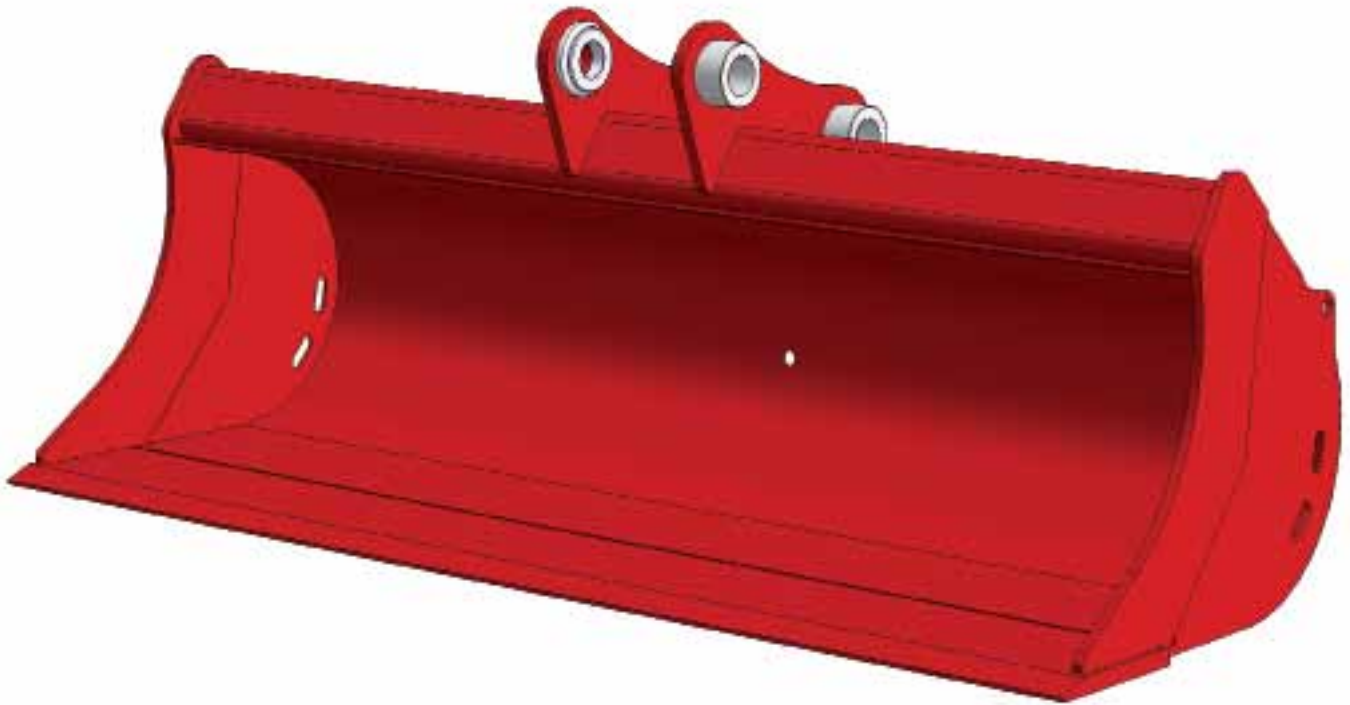

ADAPTERS



CR70

pag.86



CS80

pag.88



CS80 JANUS

pag.88



CW AUTOLOCK 10

pag.90

TECHNICAL SPECIFICATION

L/mm	 *	CAP. SAE	ATTACHMENT
1200	218	367	AF
1200	218	367	CR
1200	218	367	CS
1200	218	367	CS Janus
1200	218	367	CW
1400	251	436	AF
1400	251	436	CR
1400	251	436	CS
1400	251	436	CS Janus
1400	251	436	CW
1600	283	504	AF
1600	283	504	CR
1600	283	504	CS
1600	283	504	CS Janus
1600	283	504	CW
1800	315	573	AF
1800	315	573	CR
1800	315	573	CS
1800	315	573	CS Janus
1800	315	573	CW
2000	348	641	AF
2000	348	641	CR
2000	348	641	CS
2000	348	641	CS Janus
2000	348	641	CW

* the weight of the bucket is calculated without attachment and teeth

OPTIONAL



ADDITIONAL CUTTING EDGES

L/mm
1200
1400
1600
1800
2000

OPTIONAL

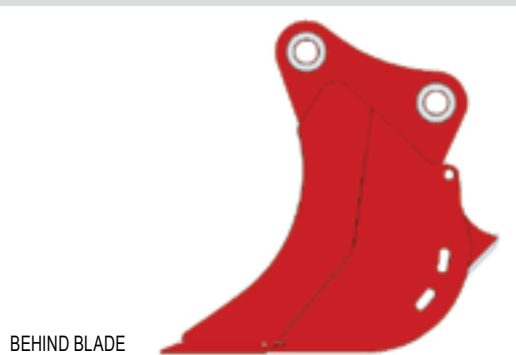

BEHIND BLADE

L/mm
1200
1400
1600
1800
2000

OPTIONAL BEHIND BLADE



OPTIONAL

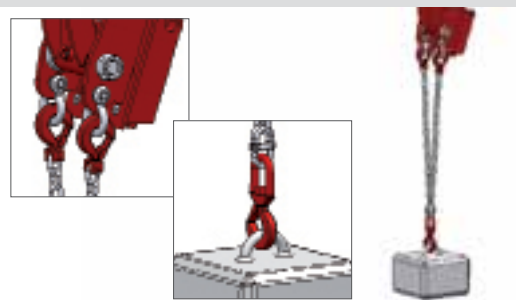

MOVEMENT HOOK

OPTIONAL



REINFORCEMENT

OPTIONAL



LATERAL CUTTERS + REINFORCE

OPTIONAL



TWIST 225

REINFORCED PIVOTING DITCH CLEANING BUCKET

Evolution of the standard ditch cleaning tilting bucket. The application of HB400 reinforcements at the points of increased wear (bottom and sides), side welded cutters and additional bolted blade make this bucket suitable to hard surfaces. The hydraulic tilting in both directions is 45°.

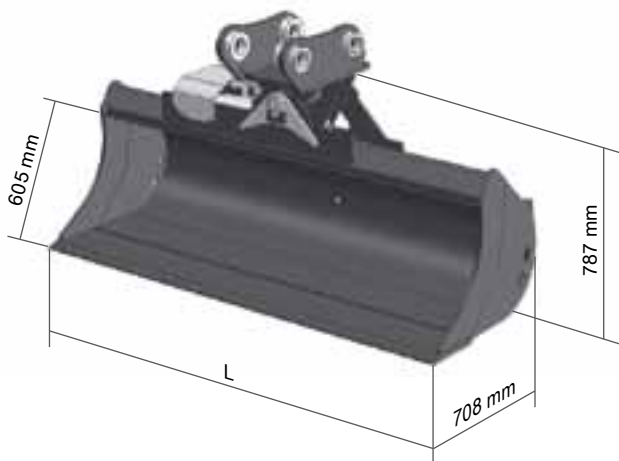
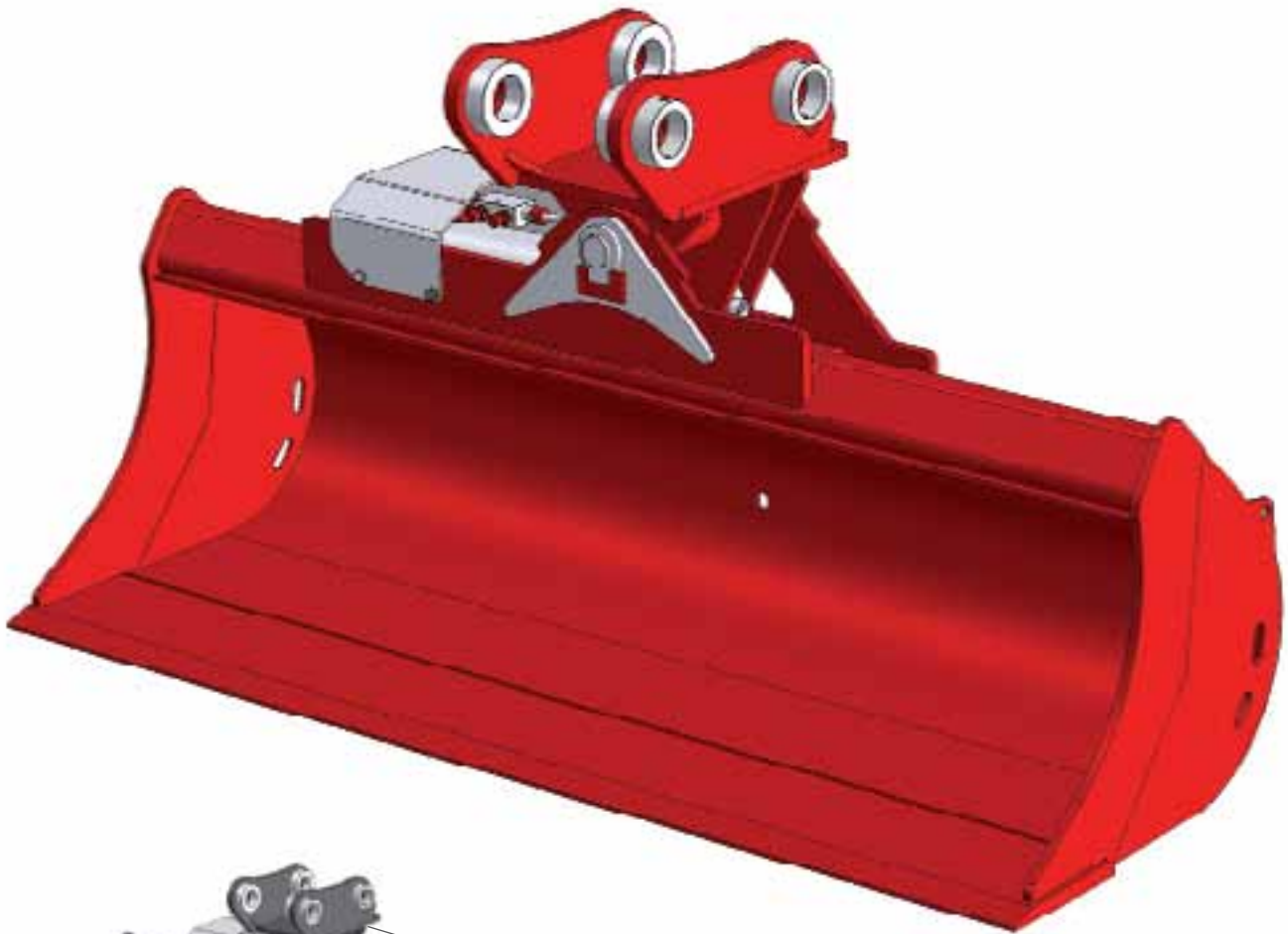

ADAPTERS



CR70

pag.86



CS80

pag.88



CS80 JANUS

pag.88



CW AUTOLOCK 10

pag.90

TECHNICAL SPECIFICATION

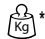
L/mm	 *	CAP. SAE	ATTACHMENT
1200	320	367	AF
1200	320	367	CR
1200	320	367	CS
1200	320	367	CS Janus
1200	320	367	CW
1400	353	436	AF
1400	353	436	CR
1400	353	436	CS
1400	353	436	CS Janus
1400	353	436	CW
1600	385	504	AF
1600	385	504	CR
1600	385	504	CS
1600	385	504	CS Janus
1600	385	504	CW
1800	417	573	AF
1800	417	573	CR
1800	417	573	CS
1800	417	573	CS Janus
1800	417	573	CW
2000	450	641	AF
2000	450	641	CR
2000	450	641	CS
2000	450	641	CS Janus
2000	450	641	CW

* the weight of the bucket is calculated without attachment and teeth

OPTIONAL



ADDITIONAL CUTTING EDGES

L/mm	
1200	
1400	
1600	
1800	
2000	

TILTING DETAIL - 45° + 45°



OPTIONAL



KIT HOSES RG

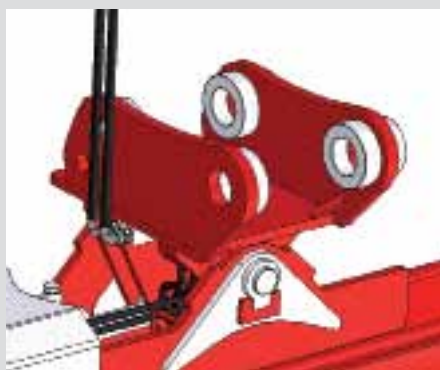

KIT HOSES LF

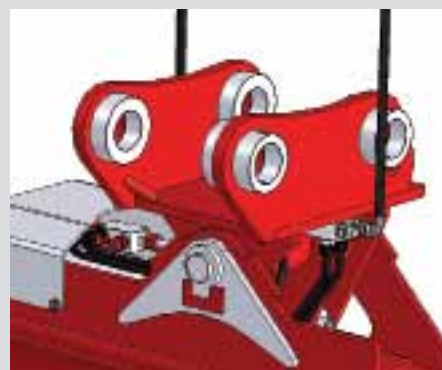

KIT HOSES RG + LF

OPTIONAL



REINFORCEMENT

OPTIONAL



LATERAL CUTTERS + REINFORCE

OPTIONAL



BEHIND BLADE

L/mm	
1200	
1400	
1600	
1800	
2000	

REINFORCED DIGGING BUCKET

Evolution of the standard digging bucket through the application of HB400 reinforcements at points of increased wear (bottom and sides), side cutters and melting "save blade". This bucket is particularly suitable for use on hard surfaces and rocky soils. It is equipped with welded capsule teeth.

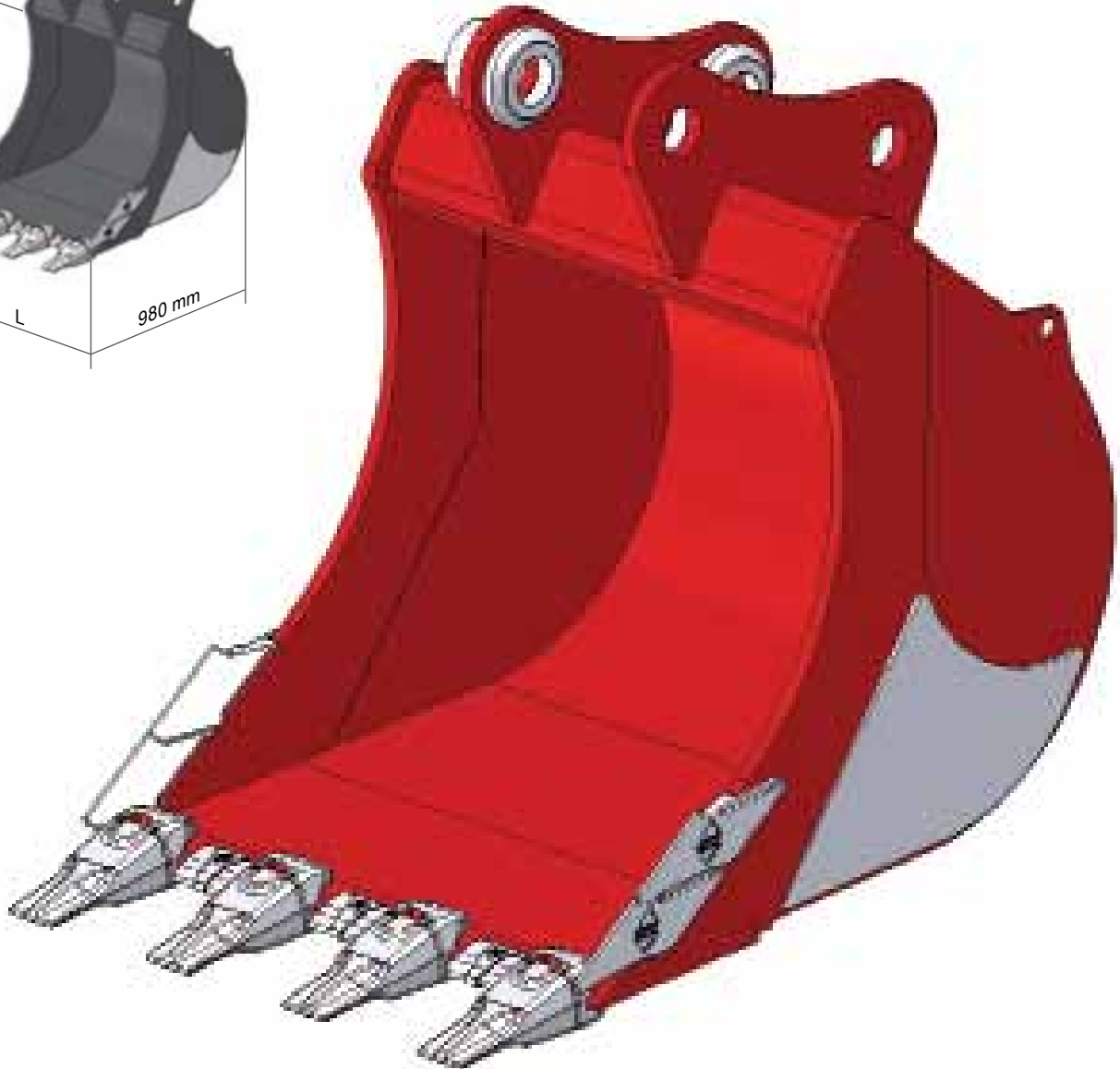
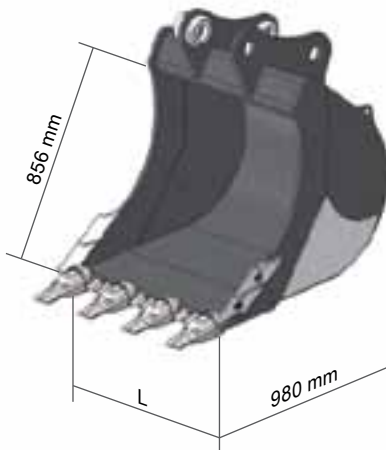

ADAPTERS



CR70

pag.86



CS80

pag.88



CS80 JANUS

pag.88



CW AUTOLOCK 10

pag.90

TECHNICAL SPECIFICATION

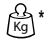
L/mm	 *	CAP. SAE	N° TEETH	ATTACHMENT
400	183	171	3	AF
400	183	171	3	CR
400	183	171	3	CS
400	183	171	3	CS Janus
400	183	171	3	CW
500	207	235	3	AF
500	207	235	3	CR
500	207	235	3	CS
500	207	235	3	CS Janus
500	207	235	3	CW
600	229	300	4	AF
600	229	300	4	CR
600	229	300	4	CS
600	229	300	4	CS Janus
600	229	300	4	CW
700	252	368	4	AF
700	252	368	4	CR
700	252	368	4	CS
700	252	368	4	CS Janus
700	252	368	4	CW
800	275	438	5	AF
800	275	438	5	CR
800	275	438	5	CS
800	275	438	5	CS Janus
800	275	438	5	CW
900	298	510	5	AF
900	298	510	5	CR
900	298	510	5	CS
900	298	510	5	CS Janus
900	298	510	5	CW
1000	326	584	5	AF
1000	326	584	5	CR
1000	326	584	5	CS
1000	326	584	5	CS Janus
1000	326	584	5	CW
1100	350	657	5	AF
1100	350	657	5	CR
1100	350	657	5	CS
1100	350	657	5	CS Janus
1100	350	657	5	CW
1200	372	730	6	AF
1200	372	730	6	CR
1200	372	730	6	CS
1200	372	730	6	CS Janus
1200	372	730	6	CW
1300	394	810	6	AF
1300	394	810	6	CR
1300	394	810	6	CS
1300	394	810	6	CS Janus
1300	394	810	6	CW

* the weight of the bucket is calculated without attachment and teeth

REINFORCE DETAILS

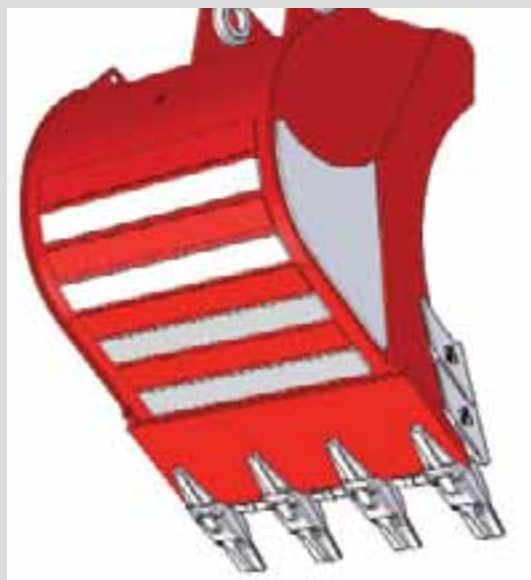

OPTIONAL



ADDITIONAL CUTTING EDGES

L/mm	L/mm
400	900
500	1000
600	1100
700	1200
800	1300

OPTIONAL



TWIST 225

pag.94

OPTIONAL

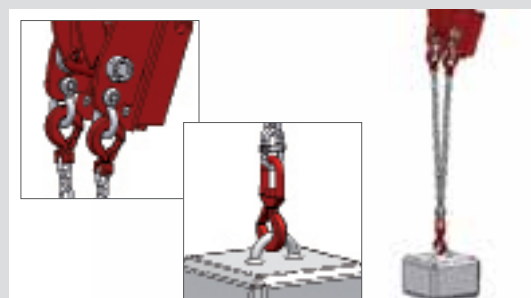

MOVEMENT HOOK

REINFORCED STONE BUCKET

Bucket designed with a washy profile to facilitate the displacement of stone blocks. Through the application of HB400 reinforcements at points of increased wear (bottom and sides), side cutters and melting save blade, this bucket is particularly suitable for use on hard surfaces and for the transport of stone blocks. This type of bucket is equipped with welded capsule teeth.

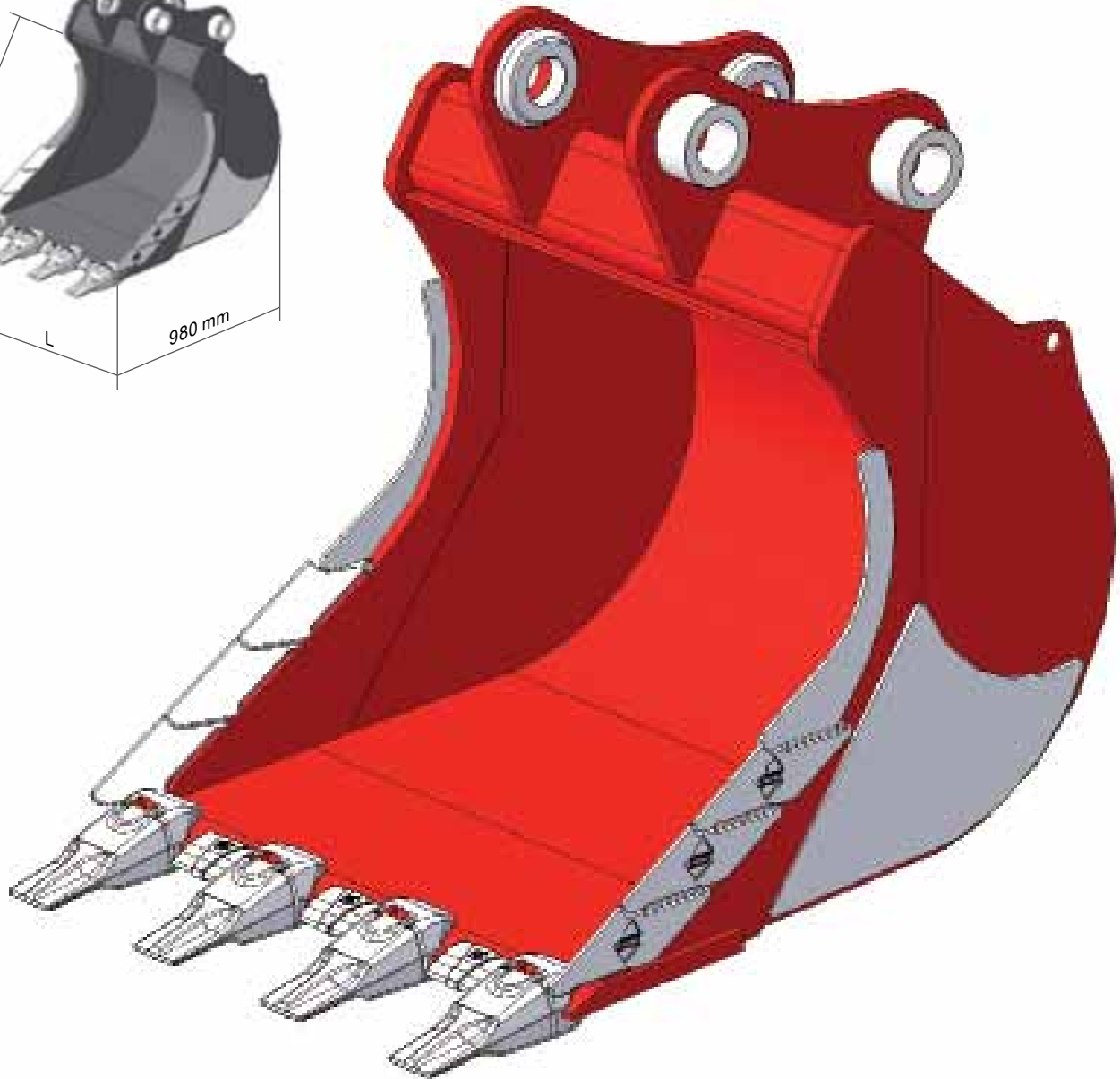
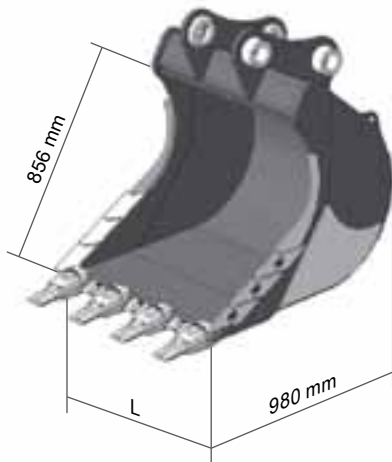

ADAPTERS



CR70

pag.86



CS80

pag.88



CS80 JANUS

pag.88



CW AUTOLOCK 10

pag.90

TECHNICAL SPECIFICATION

L/mm	 *	CAP. SAE	N° TEETH	ATTACHMENT
400	183	171	3	AF
400	183	171	3	CR
400	183	171	3	CS
400	183	171	3	CS Janus
400	183	171	3	CW
500	207	235	3	AF
500	207	235	3	CR
500	207	235	3	CS
500	207	235	3	CS Janus
500	207	235	3	CW
600	229	300	4	AF
600	229	300	4	CR
600	229	300	4	CS
600	229	300	4	CS Janus
600	229	300	4	CW
700	252	368	4	AF
700	252	368	4	CR
700	252	368	4	CS
700	252	368	4	CS Janus
700	252	368	4	CW
800	275	438	5	AF
800	275	438	5	CR
800	275	438	5	CS
800	275	438	5	CS Janus
800	275	438	5	CW
900	298	510	5	AF
900	298	510	5	CR
900	298	510	5	CS
900	298	510	5	CS Janus
900	298	510	5	CW
1000	326	584	5	AF
1000	326	584	5	CR
1000	326	584	5	CS
1000	326	584	5	CS Janus
1000	326	584	5	CW
1100	350	657	5	AF
1100	350	657	5	CR
1100	350	657	5	CS
1100	350	657	5	CS Janus
1100	350	657	5	CW
1200	372	730	6	AF
1200	372	730	6	CR
1200	372	730	6	CS
1200	372	730	6	CS Janus
1200	372	730	6	CW
1300	394	810	6	AF
1300	394	810	6	CR
1300	394	810	6	CS
1300	394	810	6	CS Janus
1300	394	810	6	CW

* the weight of the bucket is calculated without attachment and teeth

REINFORCE DETAILS

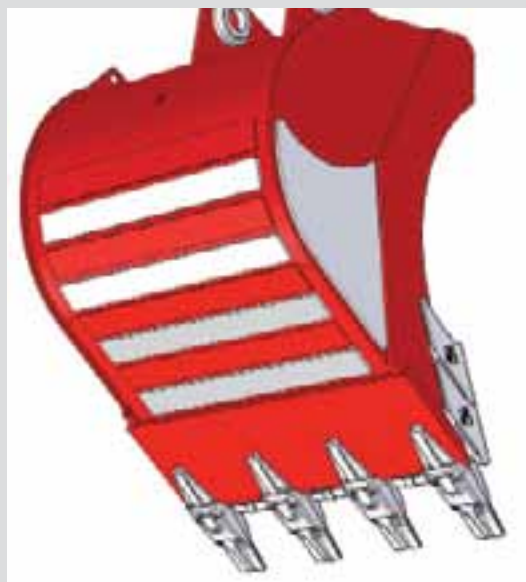

OPTIONAL



ADDITIONAL CUTTING EDGES

L/mm	L/mm
400	900
500	1000
600	1100
700	1200
800	1300

OPTIONAL



TWIST 225

pag.94

OPTIONAL

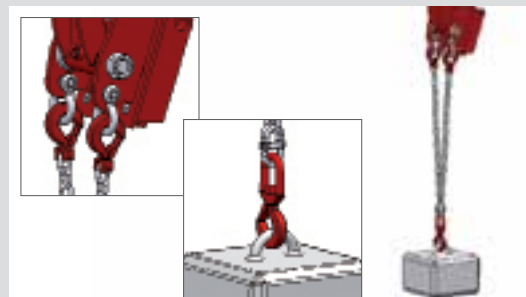

MOVEMENT HOOK

REINFORCED DITCH CLEANING BUCKET

Evolution of the standard ditch cleaning bucket. The application of HB400 reinforcements at points of increased wear (bottom and sides), the application of side welded cutters and the additional bolted blade make this bucket suitable for hard surfaces.

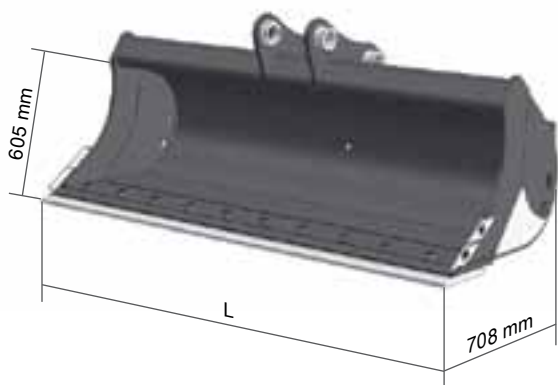
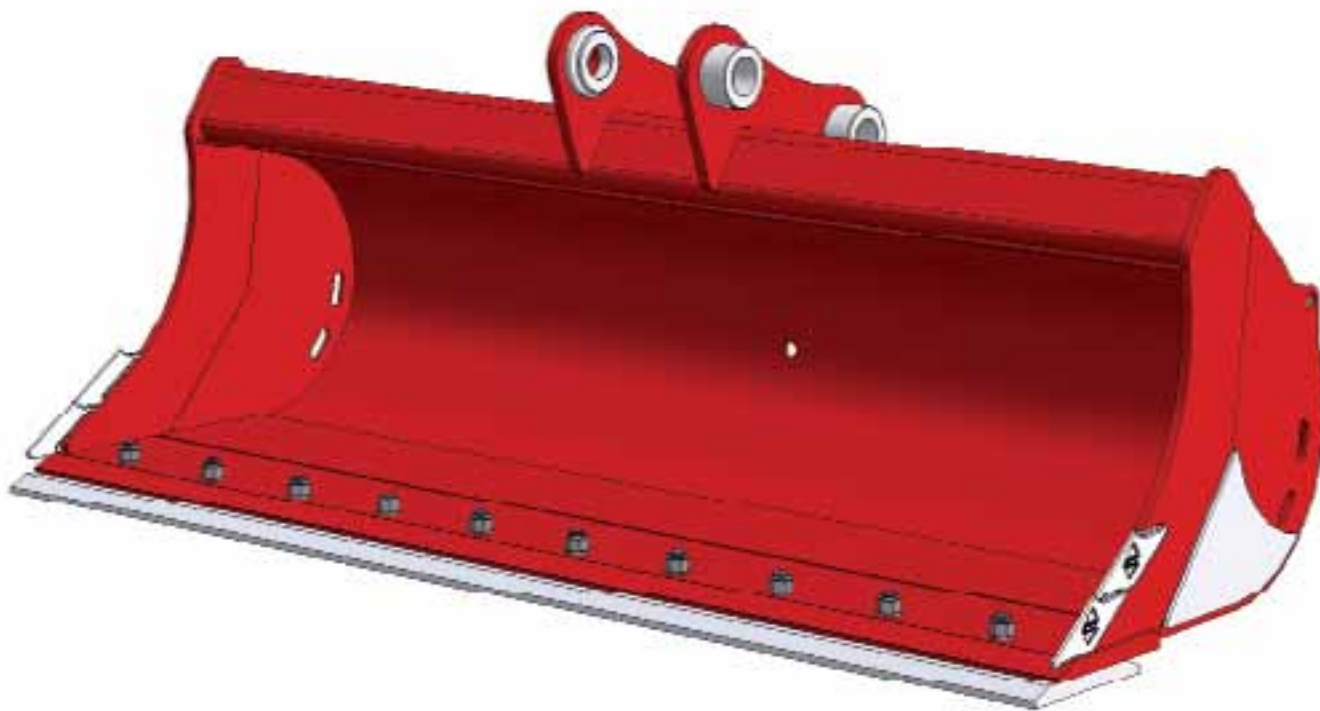

ADAPTERS



CR70

pag.86



CS80

pag.88



CS80 JANUS

pag.88



CW AUTOLOCK 10

pag.90

TECHNICAL SPECIFICATION

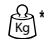
L/mm	 *	CAP. SAE	ATTACHMENT
1200	283	367	AF
1200	283	367	CR
1200	283	367	CS
1200	283	367	CS Janus
1200	283	367	CW
1400	324	436	AF
1400	324	436	CR
1400	324	436	CS
1400	324	436	CS Janus
1400	324	436	CW
1600	364	504	AF
1600	364	504	CR
1600	364	504	CS
1600	364	504	CS Janus
1600	364	504	CW
1800	404	573	AF
1800	404	573	CR
1800	404	573	CS
1800	404	573	CS Janus
1800	404	573	CW
2000	444	641	AF
2000	444	641	CR
2000	444	641	CS
2000	444	641	CS Janus
2000	444	641	CW

* the weight of the bucket is calculated without attachment and teeth

REINFORCE DETAILS



OPTIONAL

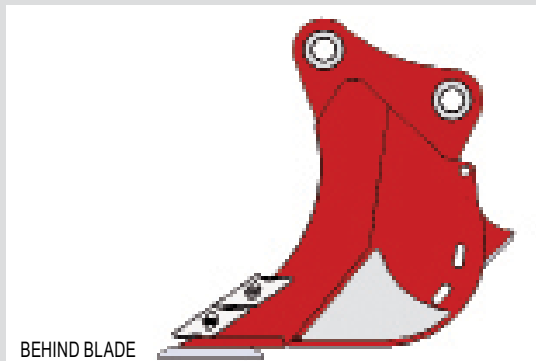

BEHIND BLADE

L/mm	
1200	
1400	
1600	
1800	
2000	

OPTIONAL BEHIND BLADE



OPTIONAL

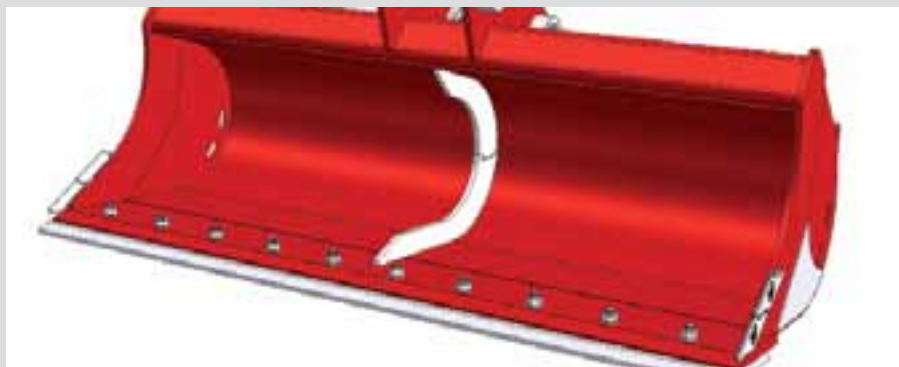

REINFORCEMENT

OPTIONAL



TWIST 225

REINFORCED PIVOTING DITCH CLEANING BUCKET

Evolution of the standard ditch cleaning tilting bucket. The application of HB400 reinforcements at the points of increased wear (bottom and sides), side welded cutters and additional bolted blade make this bucket suitable to hard surfaces. The hydraulic tilting in both directions is 45°.

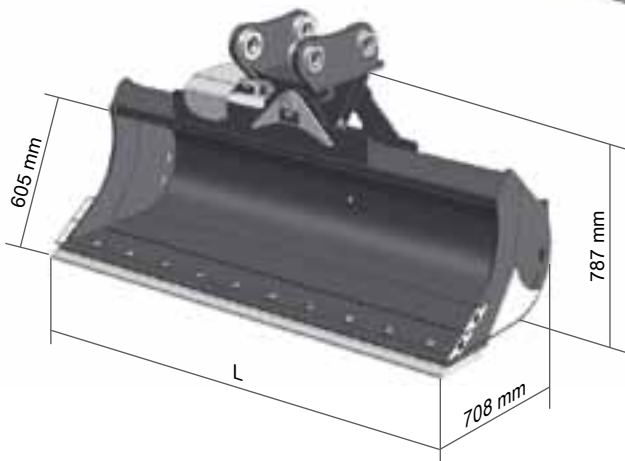
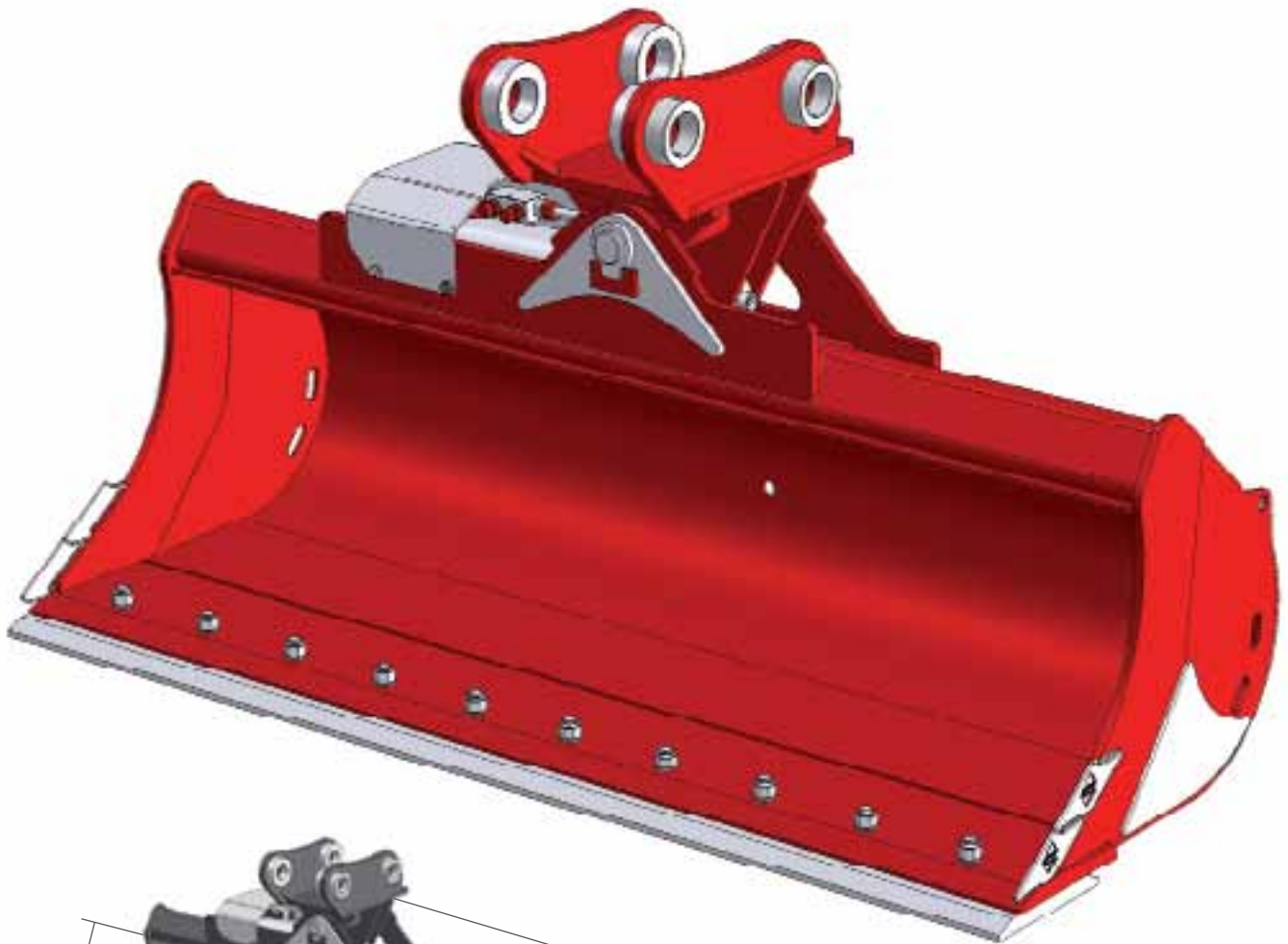

ADAPTERS



CR70

pag.86



CS80

pag.88



CS80 JANUS

pag.88



CW AUTOLOCK 10

pag.90

TECHNICAL SPECIFICATION

L/mm	 *	CAP. SAE	ATTACHMENT
1200	385	367	AF
1200	385	367	CR
1200	385	367	CS
1200	385	367	CS Janus
1200	385	367	CW
1400	426	436	AF
1400	426	436	CR
1400	426	436	CS
1400	426	436	CS Janus
1400	426	436	CW
1600	466	504	AF
1600	466	504	CR
1600	466	504	CS
1600	466	504	CS Janus
1600	466	504	CW
1800	506	573	AF
1800	506	573	CR
1800	506	573	CS
1800	506	573	CS Janus
1800	506	573	CW
2000	546	641	AF
2000	546	641	CR
2000	546	641	CS
2000	546	641	CS Janus
2000	546	641	CW

* the weight of the bucket is calculated without attachment and teeth

REINFORCE DETAILS



TILTING DETAIL - 45° + 45°



OPTIONAL



KIT HOSES RG

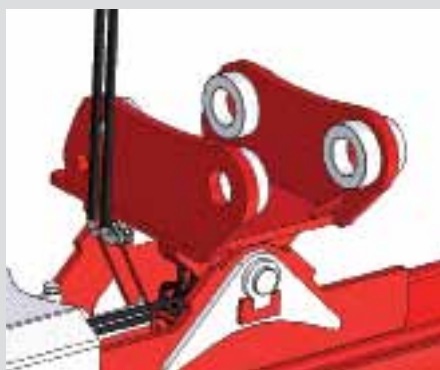

KIT HOSES LF

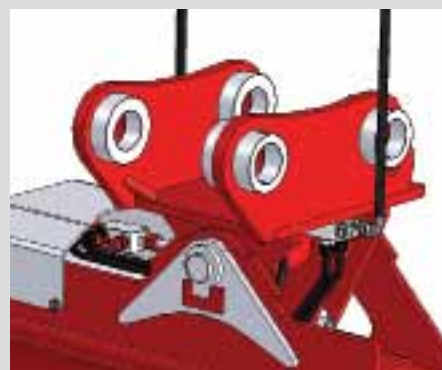

KIT HOSES RG + LF

OPTIONAL



REINFORCEMENT

OPTIONAL



BEHIND BLADE

L/mm	
1200	
1400	
1600	
1800	
2000	

